

1

2

3

4

5

6

MARK	DATE	REVISION	REVISER	APP.BY
①				
②				
③				

MODEL NO		SEWN30E		
MATERIAL		HOUSING-AL		
		HORN HOUSING-PC/ SUS316L		
USE VOLT.	CURRENT	DC12V	2.211A	
		DC24V	1.022A	
		AC110V	0.226A	
		AC220V	0.113A	
KIND OF SOUND		WS	5 Warning Sounds	
		WP	5 Special Warning Sounds	
		WM	5 Melodies	
		WA	5 Alarms	
		WV	5 Customizable sounds	
VOLUME		MAX. 118dB		
PROTECTION GRADE		WATER & DUST PROOF IP56		
CABLE ENTRY		PF1/2"		
COLOR OF HOUSING		MUNSELL NO. 7.5BG 7/2		

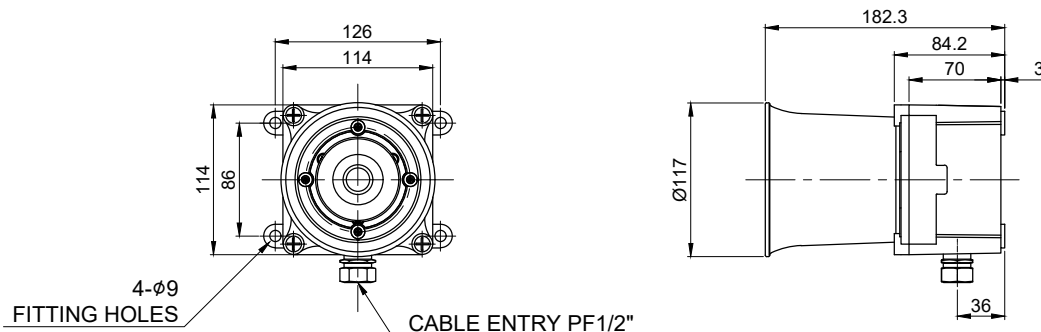

ISO2768-1 : CLASS OF TOLERANCE						SURFACE FINISH	-	-	-	-	1	-
FOR LINEAR DIMENSIONS		f	m	Ⓢ	v		Nr.	DWG. NO.	TITLE/ NAME	MAT'L	QT'Y	REFERENCE
	0.5~3	±0.05	±0.1	±0.2	-		DSND BY	CHKD BY	CHKD BY	APRV BY	VIEW	DATE
	3~6			±0.3	±0.5		J.Y. KIM	Y.H. JOO	-	J.W. KIM	3	2021.04.30
	6~30	±0.1	±0.2	±0.5	±1		TITLE			MODEL		
	30~120	±0.15	±0.3	±0.8	±1.5		SEWN30E			SEWN30E		
	120~400	±0.2	±0.5	±1.2	±2.5		OUTLINE DRAWING					
FOR ANGULAR DIMENSIONS	400~1000	±0.3	±0.8	±2	±4					SEWN30E_OUT		
	0~10	±1°		±1°30'	±3°					DWG. NO.		
	10~50	±0°30'		±1°	±2°					SCALE		
	50~120	±0°20'		±0°30'	±1°					SIZE		
	120~400	±0°10'		±0°13'	±0°30'					REV		
										SHEET		
										1/1		

A4(297X210)