

MARK	DATE	REVISION	REVISER	APP .BY
①				
②				
③				

MODEL NO	S100SOL
MATERIAL	HOUSING-ABS
	LENS-PC
	REFLECTOR-HEAT RESISTING ABS
COLOR OF LENS	RED( ), AMBER( )
FLASHES PER MIN.	60 ~ 80
BATTERY CAPA.	2.4V
FLASHES PER MIN.	0.7Ah
CONTINUOUS OPERATING TIME WITH NO CHARGE	40Hr
PROTECTION GRADE	WATER & DUST PROOF IP54
COLOR OF HOUSING	MAKER STANDARD
ACTION	SOLAR CELL LED FLASHING LIGHT

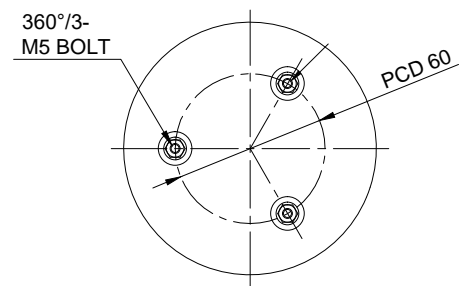
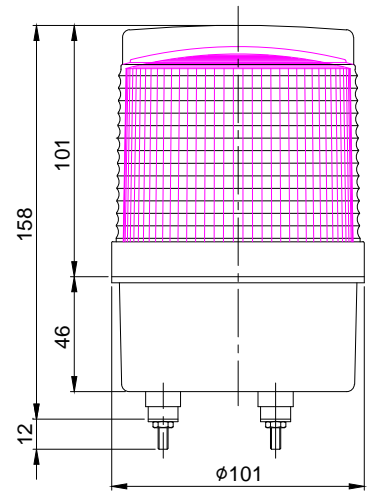

	ISO2768-1 : CLASS OF TOLERANCE					SURFACE FINISH
	f	m	Ⓢ	v		
FOR LINEAR DIMENSIONS	0.5-3	±0.05	±0.1	±0.2	-	
	3-6			±0.3	±0.5	
	6-30	±0.1	±0.2	±0.5	±1	
	30-120	±0.15	±0.3	±0.8	±1.5	
	120-400	±0.2	±0.5	±1.2	±2.5	
	400-1000	±0.3	±0.8	±2	±4	
FOR ANGULAR DIMENSIONS	0-10	±1°		±1°30'	±3°	
	10-50	±0°30'		±1°	±2°	
	50-120	±0°20'		±0°30'	±1°	
	120-400	±0°10'		±0°13'	±0°30'	

Nr.	DWG. NO.	TITLE/ NAME	MAT'L	QTY	REFERENCE
DSND BY	CHKD BY	CHKD BY	APRV BY	VIEW	DATE
Y.C.KO	J.H.PARK		J.K.HAN	3	2017.11.01
TITLE			MODEL		
S100SOL OUTLINE DRAWING			S100SOL		
			DWG. NO.		
			S100SOL_OUT		
SCALE	SIZE	REV	SHEET		
N/S	A4	00	1/1		