

MARK	DATE	REVISION	REVISER	APP. BY
Δ				
Δ				
Δ				

MODEL No.	SPR-06 / SPG-06
RECEPTACLE : CAST BRASS	
MATERIAL	PLUG : CAST BRASS PIN HOUSING : EPOXY RESIN
ELECTRICAL RATING	AC250V , 10A
INSULATION RESISTANCE	300MΩ MIN. at 500V DC
CABLE ENTRY	PF 3/4
PROTECTION GRADE	IP56

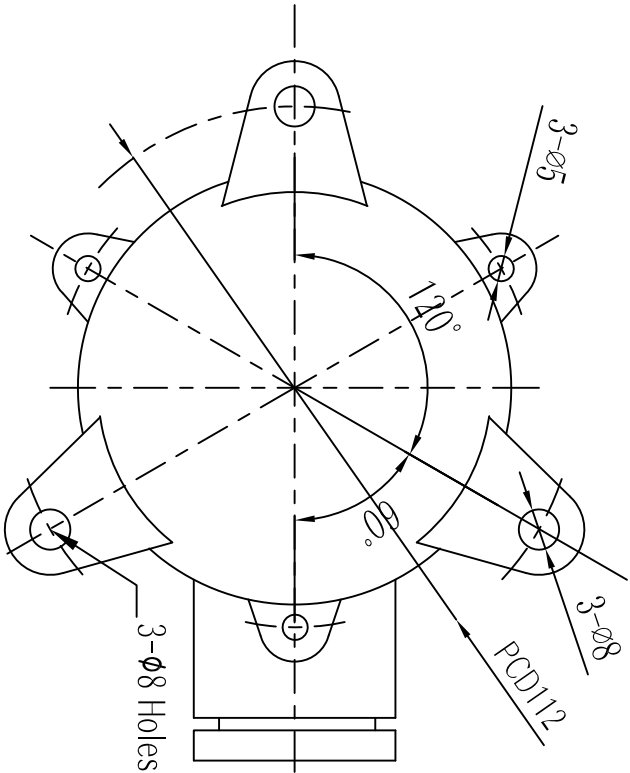
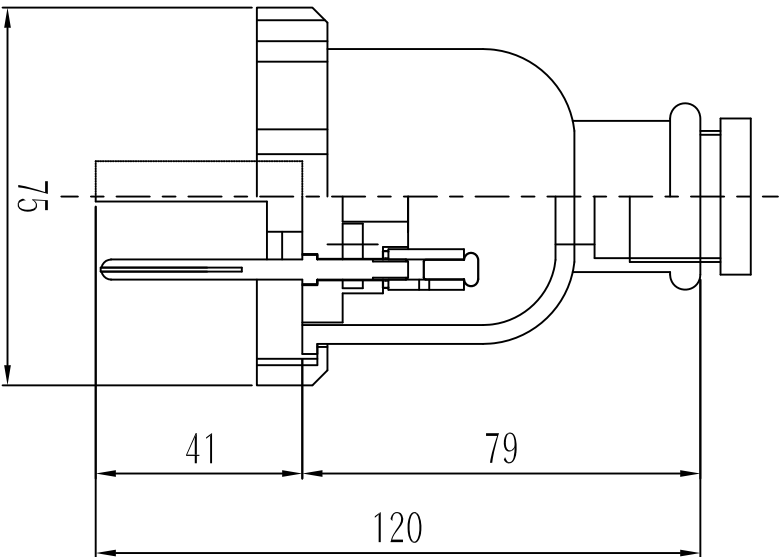
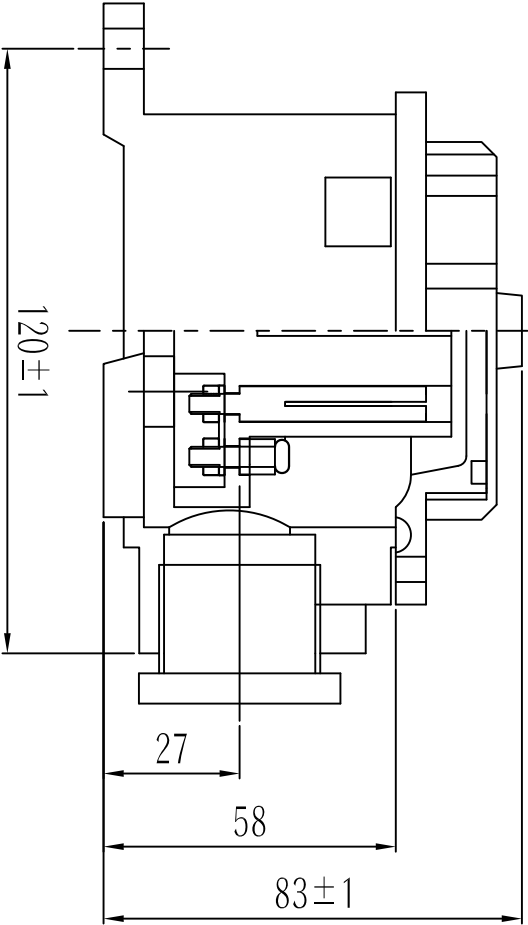

[SPR-06]

[SPG-06]

ISO2768-1 : CLASS OF TOLERANCE										SURFACE FINISH		TITLE / NAME				MAT'L		QTY		REFERENCE	
f										Ø		C				V					
FOR LINEAR DIMENSIONS																					
0.5-3										±0.05		±0.1				±0.2		—			
3-6										±0.1		±0.2				±0.3		±0.5			
6-30										±0.1		±0.3				±0.5		±1			
30-120										±0.15		±0.5				±0.8		±1.5			
120-400										±0.2		±0.5				±1.2		±2.5			
400-1000										±0.3		±0.8				±2		±4			
FOR ANGULAR DIMENSIONS																					
0-10										±1°		±1° 30'				±3°		±2°			
10-50										±0° 20'		±0° 30'				±1°		±2°			
50-120										±0° 10'		±0° 13'				±0° 30'		±1°			
120-400										±0° 10'		±0° 13'				±0° 30'		±1°			