



S80RK



S80UK

PRODUCT SPECIFICATION

S80RK | S80UK

Materials Lens-AS, Housing-ABS,

Reflector-Heat resistant ABS

Ambient operating temperature -20°C to +50°C

Protection rating IP44

Revolving speed 120-140RPM

- Ø80mm bulb revolving warning lights
- Adopts a special Power transmission system that reduces noise and wear
- Circular mount bracket allows convenient installation
- No buzzer options available

S80RK / S80UK Bulb Revolving Warning Light

Model number	Voltage	Current	Bulb			Certificates	Weight	Color
			Spec	Standard	Parts no			
S80RK S80UK	DC12V	530mA	12V5W	T16x35 15S	5	CE	0.26kg	● R-Red
	DC24V	370mA	24V5W	T16x35 15S	6		0.26kg	● A-Amber
	AC110V	80mA	12V5W	T16x35 15S	5		0.48kg	● G-Green
	AC220V	40mA	12V5W	T16x35 15S	5		0.48kg	● B-Blue

※ CE compliant: DC12V, DC24V

Technical Diagram

Units: mm

·S80RK

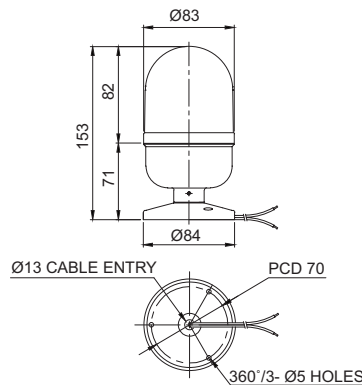

·S80UK

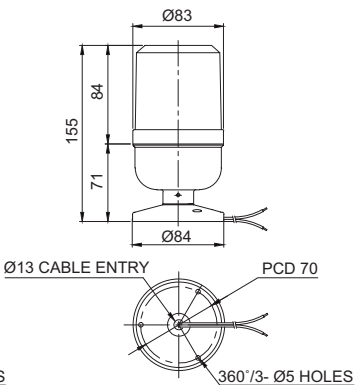

Wiring Instructions

- External Power line
UL1015 AWG18(0.75sq) x 2C 400mm
- DC Type
: Black output line is negative(-)
- AC compatible type shall be connected the black and white wires when using AC110V, and the black and red wires when using AC220V.

Wiring Instructions

- Pole mount type

Standard	LB18	LW18	QZ18	SZ18	QL18	SL18
Steel	Steel	ABS	ABS	Al	ABS	Al

※ Please refer to [Tower Light Mounting Bracket] on this catalogue for detailed dimensions

- AC compatible type: Could select AC110V or AC220V by connecting 2 Power lines of 3 wires each.

Ordering Specification

S80RK	-	24	-	R
[Model number]		[Voltage]		[Color]
S80RK S80UK		12-DC12V 24-DC24V 110-AC110V 220-AC220V		● R-Red ● A-Amber ● G-Green ● B-Blue